

Pillow Blocks

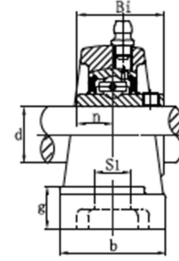
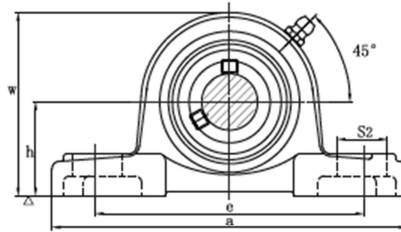

Bearing unit No.	Shaft Dia.		Dimensions(in)or(mm)										Bolt used (mm) (in.)	Bearing No.	Housing No.	weight (kg)	
	d	h	a	e	b	S2	S1	g	w	Bi	n						
UCP 201 201-8	1/2	12	3/16	5	3/4	1 1/2	3/4	1/2	19/32	2 7/16	1.2205	0.5000	M10	3/8	UC 201 201-8	P 201	0.63
UCP 202 202-10	5/8	15	3/16	5	3/4	1 1/2	3/4	1/2	19/32	2 7/16	1.2205	0.5000	M10	3/8	UC 202 202-10	P 202	0.63
UCP 203 203-11	11/16	17	3/16	5	3/4	1 1/2	3/4	1/2	19/32	2 7/16	1.2205	0.5000	M10	3/8	UC 203 203-11	P 203	0.63
UCP 204-12 204	3/4	20	5/16	5	3/4	1 1/2	3/4	1/2	19/32	2 9/16	1.2205	0.5000	M10	3/8	UC 204-12 204	P 204	0.65
UCP 205-14 205-15 205	7/8	25	1/16	5 1/2	4 1/8	1 1/2	5/8	1/2	5/8	2 3/4	1.3386	0.5630	M10	3/8	UC 205-14 205-15 205	P 205	0.79
UCP 205-16 206	1	30	3/16	6 1/2	4 9/16	1 7/8	53/64	21/32	45/64	3 17/64	1.5000	0.6200	M14	1/2	UC 205-16 206	P 206	1.3
UCP 206-18 206-19 206-20	1 1/8	35	1/8	7 1/4	5 25/64	2 1/8	63/64	21/32	3/4	15/16	1.8370	0.7480	M14	1/2	UC 206-18 206-19 206-20	P 206	1.3
UCP 207-20 207-21 207-22 207	1 1/4	40	7/16	8 1/2	6 1/4	2 3/8	63/64	25/32	55/64	4 1/2	1.6890	0.6890	M14	1/2	UC 207-20 207-21 207-22 207	P 207	1.60
UCP 207-23 208-24 208-25 208	1 1/2	45	1/2	9 1/2	7 1/4	2 3/4	63/64	25/32	63/64	5 7/16	1.8370	0.7480	M14	1/2	UC 207-23 208-24 208-25 208	P 208	2.00
UCP 209-26 209-27 209-28 209	1 5/8	50	5/8	10 1/2	8 1/2	2 7/8	63/64	25/32	55/64	4 1/2	1.8370	0.7480	M14	1/2	UC 209-26 209-27 209-28 209	P 209	2.20
UCP 210-30 210-31 210	1 7/8	55	3/4	11 1/2	9 1/2	3 1/8	63/64	25/32	55/64	4 1/2	2.0315	0.7480	M16	5/8	UC 210-30 210-31 210	P 210	2.80
UCP 210-32 211-32 211-34 211	2	60	7/8	12 1/2	10 1/2	3 1/4	63/64	25/32	55/64	4 3/4	2.1890	0.8740	M16	5/8	UC 210-32 211-32 211-34 211	P 211	3.40
UCP 211-35 212-36 212 212-38 212-39	2 1/8	65	1 1/16	13 1/2	11 1/2	3 3/4	63/64	25/32	55/64	4 3/4	2.1890	0.8740	M16	5/8	UC 211-35 212-36 212 212-38 212-39	P 211	3.40
UCP 213-40 213	2 1/4	70	1 1/8	14 1/2	12 1/2	4 1/8	63/64	25/32	55/64	4 3/4	2.5630	1.0000	M16	5/8	UC 213-40 213	P 212	4.80
UCP 214-44 214	2 3/4	75	1 1/4	15 1/2	13 1/2	4 1/2	63/64	25/32	55/64	4 3/4	2.5630	1.0000	M20	3/4	UC 214-44 214	P 213	5.70
UCP 215 215-47 215-48	3	80	1 3/8	16 1/2	14 1/2	4 3/4	63/64	25/32	55/64	4 3/4	2.9370	1.1890	M20	3/4	UC 215 215-47 215-48	P 214	7.00
UCP 216 216-50 217-52 217-55	3 1/4	85	1 5/8	17 1/2	15 1/2	5 1/8	63/64	25/32	55/64	4 3/4	3.0630	1.3110	M20	3/4	UC 216 216-50 217-52 217-55	P 215	7.80
UCP 218-56 218	3 1/2	90	1 7/8	18 1/2	16 1/2	5 3/8	63/64	25/32	55/64	4 3/4	3.2520	1.3110	M20	3/4	UC 218-56 218	P 216	9.00