

Flange Units (Oval)

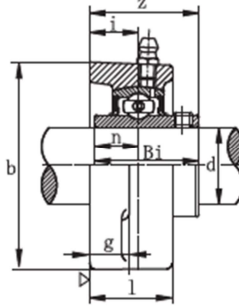
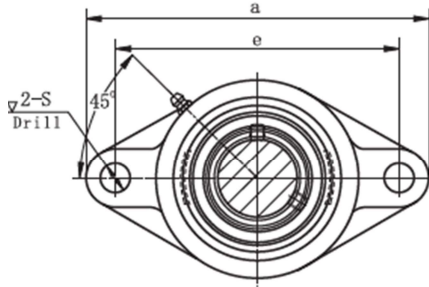

UCFL 200
normal-duty

SR type seal

TRL type seal

Bearing unit	Shaft Dia.	Dimensions(n)or(mm)											Bolt used	Bearing	Housing	Weight
No.	d	a	e	i	g	l	S	b	Z	Bi	n	No.	No.		(kg)	
	(in.) (mm)											(mm) (in.)				
UCFL 201 201-8	1/2	12	4 7/16	3 35/64	19/32	1 15/32	1	15/32	2 3/8	5/16	1,2205	0,5000	M10 3/8	UC 201 201-8	FL 201	0,49
UCFL 202 202-10	5/8	15	4 7/16	3 35/64	19/32	1 15/32	1	15/32	2 3/8	5/16	1,2205	0,5000	M10 3/8	UC 202 202-10	FL 202	0,49
UCFL 203 203-11	11/16	17	4 7/16	3 35/64	19/32	1 15/32	1	15/32	2 3/8	5/16	1,2205	0,5000	M10 3/8	UC 203 203-11	FL 203	0,49
UCFL 204-12 204	3/4	20	4 7/16	3 35/64	19/32	1 15/32	1	15/32	2 3/8	5/16	1,2205	0,5000	M10 3/8	UC 204-12 204	FL 204	0,49
UCFL 205-14 205-15 205	7/8	25	5 1/8	3 57/64	5/8	9/16	1 1/16	5/8	2 1/16	13/32	1,3386	0,5630	M14 1/2	UC 205-14 205-15 205	FL 205	0,63
UCFL 206-18 206	1 1/8	30	5 13/16	4 39/64	45/64	9/16	1 7/32	5/8	3 5/32	1 9/32	1,5000	0,6260	M14 1/2	UC 206-18 206	FL 206	0,94
UCFL 206-19 206-20	1 3/16	30	5 13/16	4 39/64	45/64	9/16	1 7/32	5/8	3 5/32	1 9/32	1,5000	0,6260	M14 1/2	UC 206-19 206-20	FL 206	0,94
UCFL 207-20 207-21 207-22 207	1 1/4	35	6 1/2	5 1/8	3/4	5/8	1 1/32	5/8	3 17/32	1 3/4	1,6890	0,6890	M14 1/2	UC 207-20 207-21 207-22 207	FL 207	1,2
UCFL 207-23 208-24 208-25 208	1 7/16	40	6 7/8	5 43/64	53/64	5/8	1 13/32	5/8	3 15/16	2 1/64	1,9370	0,7480	M14 1/2	UC 208-24 208-25 208	FL 208	1,6
UCFL 208-26 209-27 209-28 209	1 5/8	45	7 13/32	5 53/64	55/64	23/32	1 1/2	3/4	4 1/4	2 1/16	1,9370	0,7480	M16 5/8	UC 209-26 209-27 209-28 209	FL 209	1,9
UCFL 210-30 210-31 210	1 7/8	50	7 3/4	6 3/16	55/64	23/32	1 9/16	3/4	4 17/32	2 5/32	2,0315	0,7480	M16 5/8	UC 210-30 210-31 210	FL 210	2,2
UCFL 210-32 211-32 211	2	55	8 1/2	7 1/4	63/64	25/32	1 1/16	3/4	5 1/8	2 19/64	2,1890	0,8740	M16 5/8	UC 211-32 211-32 211	FL 211	3,2
UCFL 211-35 212-36 212	2 3/16	60	9 27/32	8 1/4	63/64	25/32	1 1/8	29/32	5 1/2	2 45/64	2,5630	1,0000	M 20 3/4	UC 212-36 212 212-38 212-39	FL 212	4,1
UCFL 212-38 212-39	2 3/8	60	9 27/32	8 1/4	63/64	25/32	1 1/8	29/32	5 1/2	2 45/64	2,5630	1,0000	M 20 3/4	UC 212-36 212 212-38 212-39	FL 212	4,1
UCFL 213-40 213	2 1/2	65	10 5/32	8 17/64	3 1/16	15/16	3 1/32	29/32	6 3/32	3 3/4	2,5630	1,0000	M 20 3/4	UC 213-40 213	FL 213	5,1
UCFL 214-44 214	2 3/4	70	10 7/16	8 1/2	1 3/32	15/16	2 1/8	29/32	6 5/16	2 3/32	2,9370	1,1890	M 20 3/4	UC 214-44 214	FL 214	5,9
UCFL 215 215-48	3	75	10 13/16	8 55/64	3 3/8	55/64	2 1/4	29/32	6 1/2	3 3/8	3,0630	1,3110	M 20 3/4	UC 215 215-48	FL 215	6,4
UCFL 216 216-50	3 1/8	80	11 3/32	9 1/64	1 3/8	29/32	2 1/4	63/64	7 3/32	3 21/64	3,2520	1,3110	M 22 7/8	UC 216 216-50	FL 216	7,9
UCFL 217-52 217	3 1/4	85	12 9/64	1 64	1 1/32	2 1/32	63/64	7 19/32	3 7/16	3,3740	1,3425	M 22 7/8	UC 217-52 217	FL 217	9,6	
UCFL 218-56 218	3 1/2	90	12 3/32	10 7/16	1 37/64	1 1/32	43/64	63/64	8 1/16	3 5/64	3,7795	1,5630	M 22 7/8	UC 218-56 218	FL 218	12,1